

MISENO

Specification-sheet

Model: MNO26LD, MNO30LD, MNO36LD, MNO48LD, MNO60LD

Product Features:



- A stylish alternative to the standard strainer shower drain.
- Compatible with most standard 2" floor drains.
- Constructed of SS304 grade stainless steel which provides enhanced resistance to corrosion as well as a sturdy support for the grate and bathers.
- Use the included lifting key to easily remove the grate for cleaning and maintenance.
- Square patterned grate combines beauty, strength and function that complements any décor.
- Included strainer protects the drain from potential blockage.
- cUPC/IAPMO listed
- This product meets ASME A112.18.2-2015/CSA B125.2



Warranty

MISENO inspects all of its products prior to shipment. We offer a 1-year Limited warranty on our Linear Shower Drain products. Defective products should be returned to place of purchase for replacement. However, if this is not possible, we accept returns on defective product with our written authorization. Returns will be handled by product replacement. Defects or damage caused to product by the consumer are not accepted.



MISENO

Specification-sheet

Model: MNO26LD, MNO30LD, MNO36LD, MNO48LD, MNO60LD

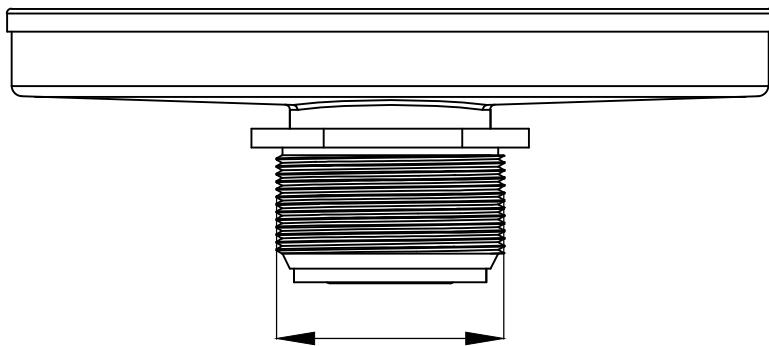

2"-11.5NPSM-2A

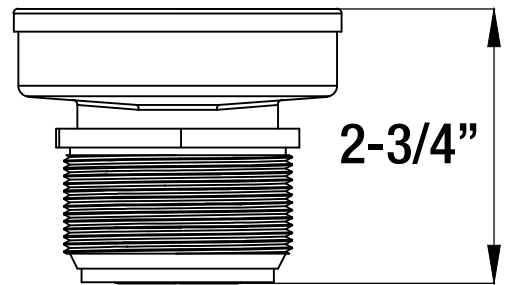

2-3/4"

26", 30", 36", 48", 60"

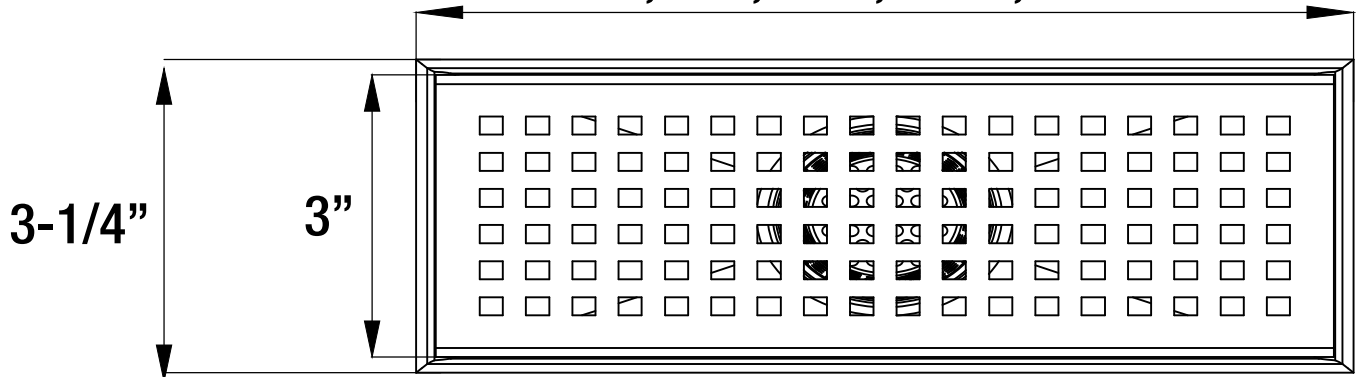

3-1/4"

3"

